

American Standard

SHOWER SYSTEMS

TWO WAY OR THREE WAY IN-WALL DIVERTER

Installation Instructions

TWO WAY: R420
THREE WAY: R430

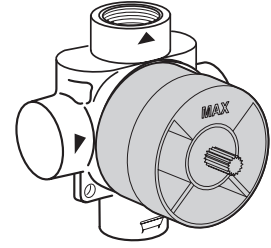

Thank you for selecting American-Standard...the benchmark of fine quality for over 100 years.

To ensure that your installation proceeds smoothly—please read these instructions carefully before you begin.

Certified to comply with ANSI A112.18.1M

50321REV. 1.1

Recommended Tools



Flat Blade Screwdriver

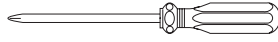

Phillips Screwdriver

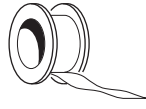

Teflon Tape



Adjustable Wrench

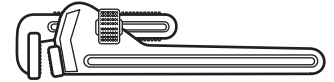

Pipe Wrench

ROUGHING-IN DIMENSIONS

NOTE: NO CONCEALED PIPING FURNISHED

CAUTION: DO NOT SEAL ANY OUTLETS. DIVERTER CANNOT BE USED AS A STOP VALVE.

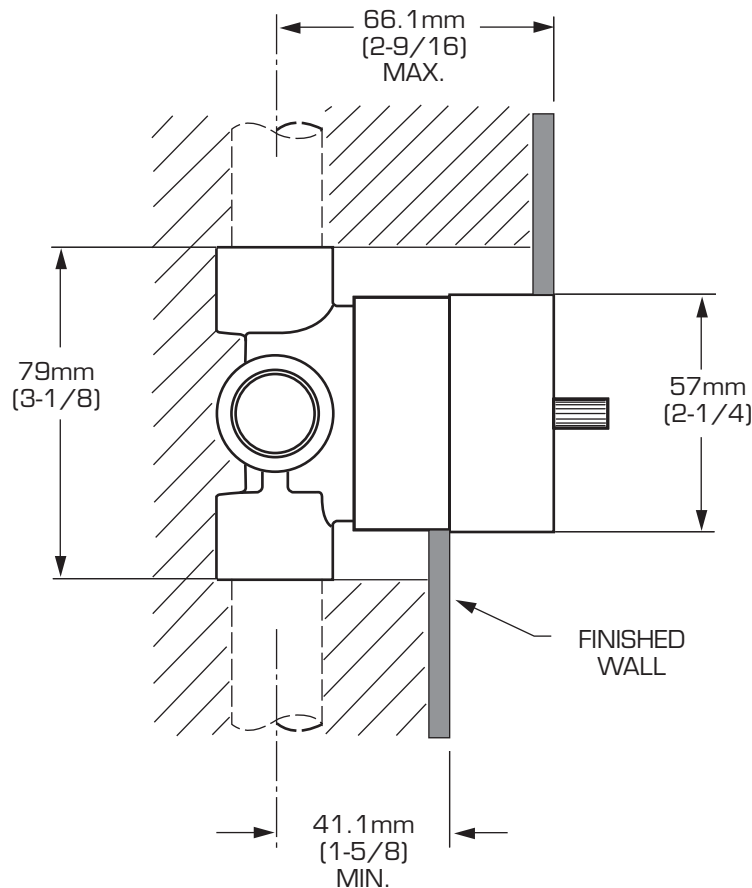

ALL CONNECTIONS 1/2" NPT

1

ROUGHING-IN

CAUTION

Turn off hot and cold water supplies before beginning.

- See Roughing-in Drawing on cover page. The port with the BATH TUB picture is the high flow.
- The DIVERTER can be installed with the inlet rotated in any position.
- Supply connections are 1/2" NPT connections.
- For proper positioning the finished wall must be within side of PLASTER GUARD.
- Connect water to valve. The reverse side of the body is marked with arrows.
CAUTION: Do not solder near the VALVE. Damage to the SEAL may occur.
Do not seal any outlets. The DIVERTER cannot be used as a stop valve.
- For support use pipe braces secured to wooden braces.

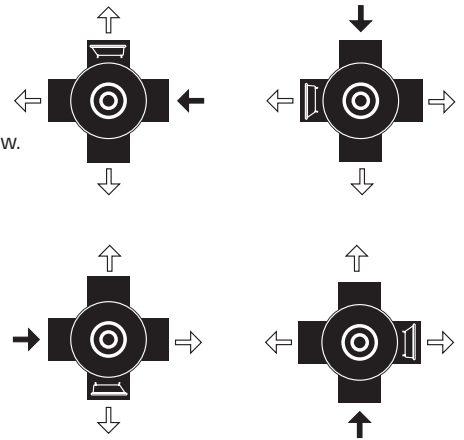

2

TEST DIVERTER

- Check that the DIVERTER operates correctly and does not leak. To do this, screw off the PLASTER GUARD, turn around, and insert using the fluted pin into the fluting on the DIVERTER SPINDLE and use as a diverter knob. Screw the PLASTER GUARD back on. Have the wall tiled only with the PLASTER GUARD screwed on.

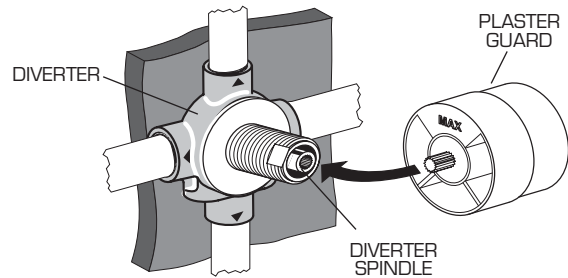

3

INSTALL TRIM

- After finished wall is complete, remove PLASTER GUARD.
- See separate installation instructions supplied with trim kit for handle assembly.

4

SERVICE

To Replace O-Rings:

- Turn off water supply.
For R420 AND R430:
- Unscrew CAP (1) and remove STEM (2), SPRING (3) and DISKS (4, 4a) and SEALS (5).
- Remove old DIVERTER elements and install new parts.
- Re-assemble in reverse order.

